

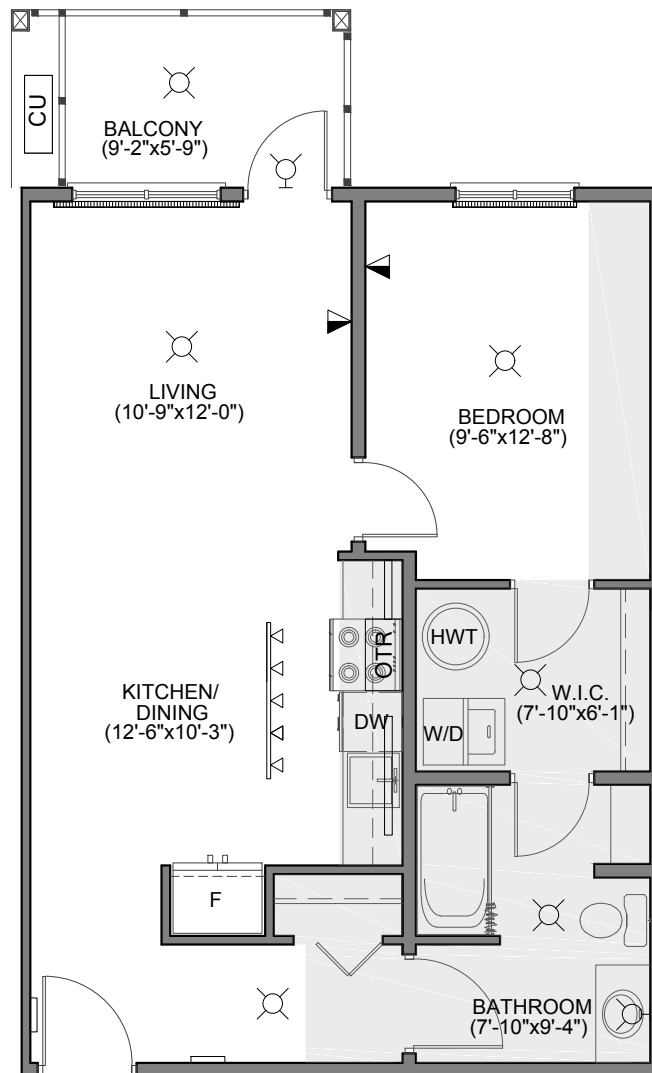

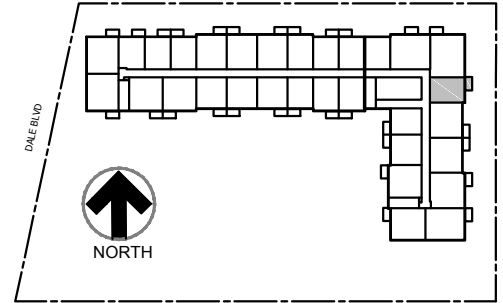





FAIRMONT III-B

545 DALE BOULEVARD
646 SQ.FT.
1 BEDROOM + BALCONY
309, 409

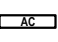
SCHEDULE "D"
FLOOR PLAN

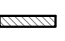
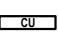
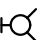
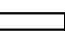

SYMBOL SCHEDULE

| | | | | | |
|---|----------------------------------|---|---|---|------------------------------------|
|  | DROPPED DRYWALL CEILING/BULKHEAD |  | ELECTRICAL PANEL (RECESSED) |  | WALL MOUNTED AIR CONDITIONING UNIT |
|  | CEILING MOUNTED LIGHT FIXTURE |  | DEMARCATION PANEL - MTS / SHAW (RECESSED) |  | FLOOR MOUNTED CONDENSING UNIT |
|  | WALL MOUNTED LIGHT FIXTURE |  | UNDER CABINET LIGHTS |  | OVER RANGE VENTILATION HOOD |
| | |  | TV / PHONE OUTLET |  | BASEBOARD HEATER |

NOTES:

1. Revisions to suite floor plans will not be permitted.
2. Interior flooring is carpet for bedrooms and the remainder is vinyl plank. (Unless noted)
3. Bathtubs and/or showers are one-piece acrylic.
4. Balcony enclosures are not permitted.
5. Suite area calculated from outside of common and exterior walls and center of shared walls.
6. Balcony of 4th floor suites will have a wall mounted light fixture; the remainder will have a potlight.
7. Interior AC unit mounted 6"-6" above the floor.
8. Floor to ceiling drywall height is 8'-0" and 7'-0" as per plan in bathrooms, closets & bulkhead locations

Plans and prices are subject to change without notice. The Builder reserves the right to change the material or specifications without notice but guarantees that change will be equal or of similar value. Room dimensions are approximate. All illustrations are artist's concept and may vary. Drawing is not to scale. BW (05/30/16) REV0

/

Initials