

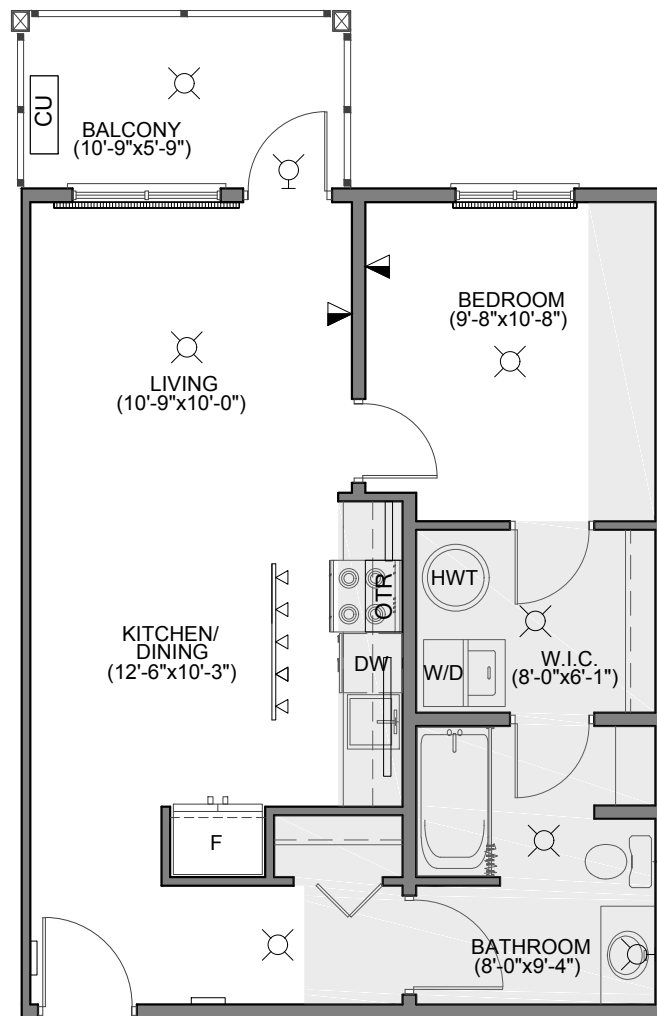

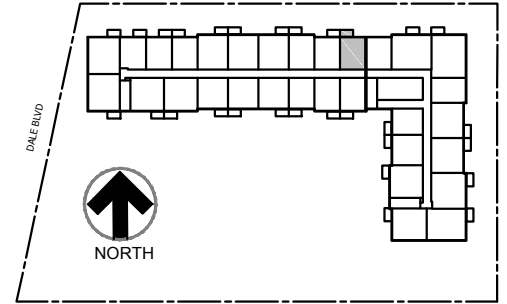





FAIRMONT V-A

545 DALE BOULEVARD
615 SQ.FT.
1 BEDROOM + BALCONY
114, 214, 314, 414

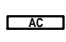
SCHEDULE "D"
FLOOR PLAN

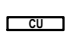
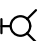
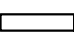

SYMBOL SCHEDULE

	DROPPED DRYWALL CEILING/BULKHEAD		ELECTRICAL PANEL (RECESSED)		WALL MOUNTED AIR CONDITIONING UNIT
	CEILING MOUNTED LIGHT FIXTURE		DEMARICATION PANEL - MTS / SHAW (RECESSED)		FLOOR MOUNTED CONDENSING UNIT
	WALL MOUNTED LIGHT FIXTURE		UNDER CABINET LIGHTS		OVER RANGE VENTILATION HOOD
			TV / PHONE OUTLET		BASEBOARD HEATER

NOTES:

1. Revisions to suite floor plans will not be permitted.
2. Interior flooring is carpet for bedrooms and the remainder is vinyl plank. (Unless noted)
3. Bathtubs and/or showers are one-piece acrylic.
4. Balcony enclosures are not permitted.
5. Suite area calculated from outside of common and exterior walls and center of shared walls.
6. Balcony of 4th floor suites will have a wall mounted light fixture; the remainder will have a potlight.
7. Interior AC unit mounted 6"-6" above the floor.
8. Floor to ceiling drywall height is 8'-0" and 7'-0" as per plan in bathrooms, closets & bulkhead locations

Plans and prices are subject to change without notice. The Builder reserves the right to change the material or specifications without notice but guarantees that change will be equal or of similar value. Room dimensions are approximate. All illustrations are artist's concept and may vary. Drawing is not to scale. BW (05/30/16) REV0

/
Initials